

# How to dispose of home computers

Please dispose of computers no longer needed at home in the following manner. **The city does not collect them.**

## Collection by Sagawa Express

Free collection of disused home PCs by courier service is offered by Renet Japan Recycle Inc., under the "Small Home Appliance Recycle Law" and the agreement with the city.

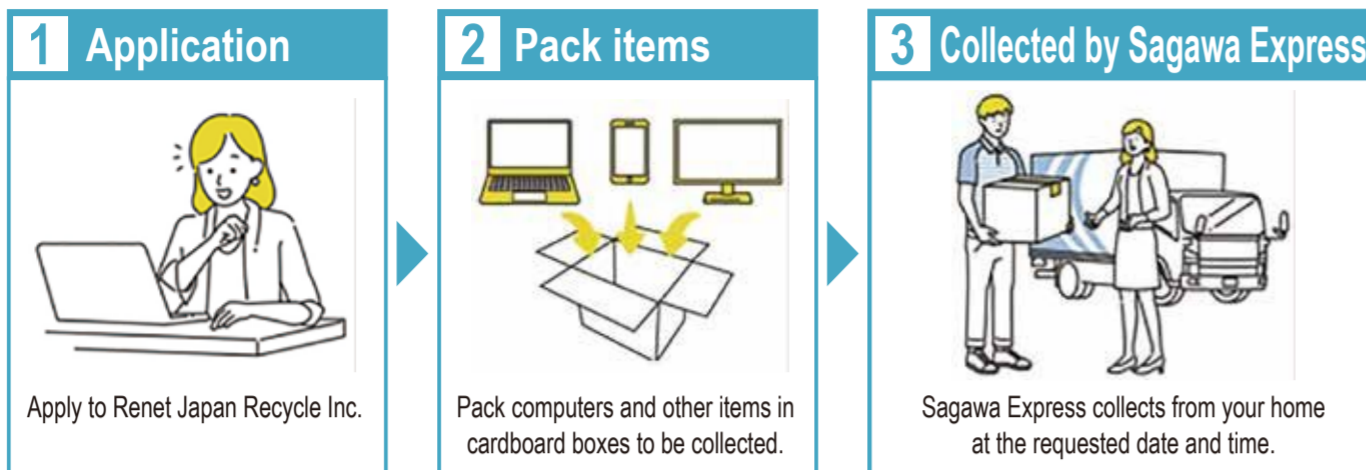

- Make sure to delete all data yourself beforehand. (Free data erasure software is available.)
  - Collection fee for 1 cardboard box containing a PC is free. (The sum of the three sides of the box must not exceed 140cm, less than 20kg )
  - Other small appliances, printers and other computer accessories can be collected together.
- \* See right side for details and application.

## Manufacturer collection

Contact the manufacture you purchased from. Please contact the following for self-built PCs or PCs of unknown manufacturer.

### PC3R Promotion Association

URL : <https://www.pc3r.jp/>

TEL : 03-5282-7685

※ Open from Monday to Friday, excluding the year-end and New Year holidays and national holidays  
Opening hours: 9 a.m.-12 p.m. | 1 p.m.-5 p.m.

A recycling fee is required if the PC Recycle Mark on the right is not attached.



### Renet Japan Recycle, Inc.

URL : <https://www.renet.jp/>

TEL : 0570-085-800  
(10 a.m.-5 p.m)



Renet Japan Search

## How to dispose of items subject to the Home Appliance Recycling Law

Air-conditioners, TVs, refrigerators, freezers, washing machines, and clothes dryers are required to be picked up and recycled by manufacturers by law. Therefore **the city does not collect them**. Please dispose of them by the following manner. (Recycling fee, and collection and transportation fee are required.)

### For replacement

Request the store where the new product is purchased to pick up the old one.

### Other than replacement

- ① Request the store where you purchased the product to pick it up.
- ② Request pick-up at a cooperative store for home appliance recycling collection.
- ③ Purchase a home appliance recycling ticket at a post office and bring it directly to the pick-up location designated by manufacturer.

- ※ Cooperating stores for home appliance recycling collection in the city can be found on the city website and "threeR" App.
- ※ How to purchase tickets and how to pay the recycling fee.



▲ Tsukuba City's official website

### Association for Electric Home Appliances

#### Kaden Recycle-ken Center

TEL : 0120-319-640

Opening hours: 9 a.m. - 6 p.m.

(closed on Sundays and national holidays)

## Disaster debris



General garbage rules do not apply to disaster debris, such as wet furniture that cannot be reused.

You can find information on how to dispose of disaster debris and how to prepare for disasters in the handbook titled *Tsukuba-shi Saigai Haikibutsu Shori Handbook* (つくば市災害廃棄物処理ハンドブック).

The handbook is available on the official website of Tsukuba City.



## Small rechargeable batteries to be recycled

### [Items for collection]

Lithium-ion batteries  
Nickel-metal hydride batteries  
Nicad batteries



Lithium-ion batteries



Nickel-metal hydride batteries

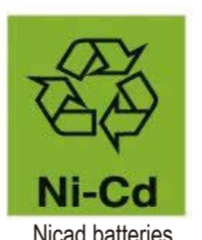

Nicad batteries

**The following batteries cannot be collected**

Damaged or dismantled battery packs  
Batteries removed from battery packs  
Wet or swollen battery packs

### How to put out

Insulate both poles of the battery with plastic tape or other insulation and put the batteries into the recycling box.

### Collection site

**Tsukuba City Hall, Sustaina Square, electronics stores and other places**

※ The fee will be charged to bring in Sustaina-Square.

※ You can search on the JBRC website for a cooperating collection points that have a recycling box. (Japanese only)

**Japan Portable Rechargeable Battery Recycling Center**

URL : <https://www.jbrc.com>

TEL : 03-6403-5673

## Please follow the rules. There has been a fire accident involving a garbage truck!

The fire accidents seems to have been possibly caused by highly flammable gases.

- Spray cans and cassette cylinders should be **completely used up** and put out on **the day of spray cans** after punching a hole in them.
- Disposable lighters should be **completely out of gas** before disposing of them on the collection day.
- **Non-burnable garbage** must be placed in a transparent or semi-transparent plastic bag.

※ For information on venting spray cans, contact the selling agencies or the consumer service center written on the products.

※ Ask **Japan Industrial Association of Gas and Kerosene Appliances** about how to dispose of unused cassette cylinders.  
Customer Service 0120-14-9996

※ See **The Japan Smoking Articles Corporate Association** website about how to vent of disposable lighters.

**Venting and punching a hole should be done in a safe place with no fire.**

